

**THE COUNCIL OF THE BOROUGH OF MILTON KEYNES
(THE COUNCIL OF THE BOROUGH OF MILTON KEYNES)
(VARIOUS ROADS, WAVENDON) (PROHIBITION OF WAITING AND
LOADING RESTRICTIONS) ORDER 2012) VARIATION ORDER 2017**

The Council of the Borough of Milton Keynes ("the Council") in exercise of its powers under sections 1(1), 2(1) and (2), 4(2), and Part IV of Schedule 9 of the Road Traffic Regulation Act 1984 ("the Act of 1984") and of all other enabling powers, and after consultation with the chief officer of Police in accordance with Part III of Schedule 9 to the Act of 1984, hereby makes the following Order:-

PART 1

IMPLEMENTATION AND CIATATION

1. This Order shall come into operation on the 27th day of February 2017 and may be cited as "The Council of the Borough of Milton Keynes (The Council of the Borough of Milton Keynes) (Various Roads, Wavendon) (Prohibition of Waiting and Loading Restrictions) Order 2012) Variation Order 2017".
2. Any reference in this Order to any enactment shall be construed as a reference to that enactment as amended by any subsequent enactment.
3. The plan annexed to this Order identifies the lengths of road subject to this Order, provided that where there is any inconsistency between the plan and Schedules it is the wording of the Schedules which shall prevail.
4. The plan annexed to this Order is hereby annexed to The Council of the Borough of Milton Keynes (The Council of the Borough of Milton Keynes) (Various Roads, Wavendon) (Prohibition of Waiting and Loading Restrictions) Order 2012

PART 2

VARIATIONS

5. The Council of the Borough of Milton Keynes (The Council of the Borough of Milton Keynes) (Various Roads, Wavendon) (Prohibition of Waiting and Loading Restrictions) Order 2012 ("The Principal Order") is varied as provided by the following provisions of this Order:-
6. Items NW1 and NW2 in Schedule 1 of the principal Order is revoked and replaced by the following:-

STOCKWELL LANE, WAVENDON

NORTH-EAST SIDE

NW1 From its junction with the northern kerblin of Walton Road, continuing for a distance of 40.6 metres in a northerly direction

NORTH-WEST SIDE

NW2 From its junction with the northern kerblin of Walton Road, continuing for a distance of 32.2 metres in a northerly direction

7. The following items are inserted into SCHEDULE 1 of the Principal Order:-

THE JUNCTION OF A5130 NEWPORT ROAD AND WALTON ROAD, WAVENDON

SOUTH-WEST SIDE AND NORTH-WEST SIDE

NW3 From a point on A5130 Newport Road 20 metres north of the centreline of Walton Road, continuing for a distance of 39 metres in a southerly then westerly direction onto and along Walton Road

SOUTH-WEST SIDE AND SOUTH-EAST SIDE

NW4 From a point on A5130 Newport Road 29 metres south of the centreline of Walton Road, continuing for a distance of 39 metres in a northerly then westerly direction onto and along Walton Road

WALTON ROAD, WAVENDON

NORTH-WEST SIDE

NW5 From a point 11.7 metres west of a point in line with the western kerblin of Phoebe Lane, continuing for a distance of 9 metres in a westerly and south-westerly direction

NW6 From its junction with the eastern kerblin of St Mary's Close, continuing for a distance of 21.2 metres in a easterly direction

SOUTH-EAST SIDE

NW7 From a point 16.7 metres west of the western kerblin of Phoebe Lane, continuing for a distance of 50.8 metres in a westerly direction

NW8 From a point 7.5 metres west of the shared boundary line of numbers 15 and 17 Walton Road, continuing for a distance of 38.6 metres in a westerly direction

MAP 1 FOR ORDER

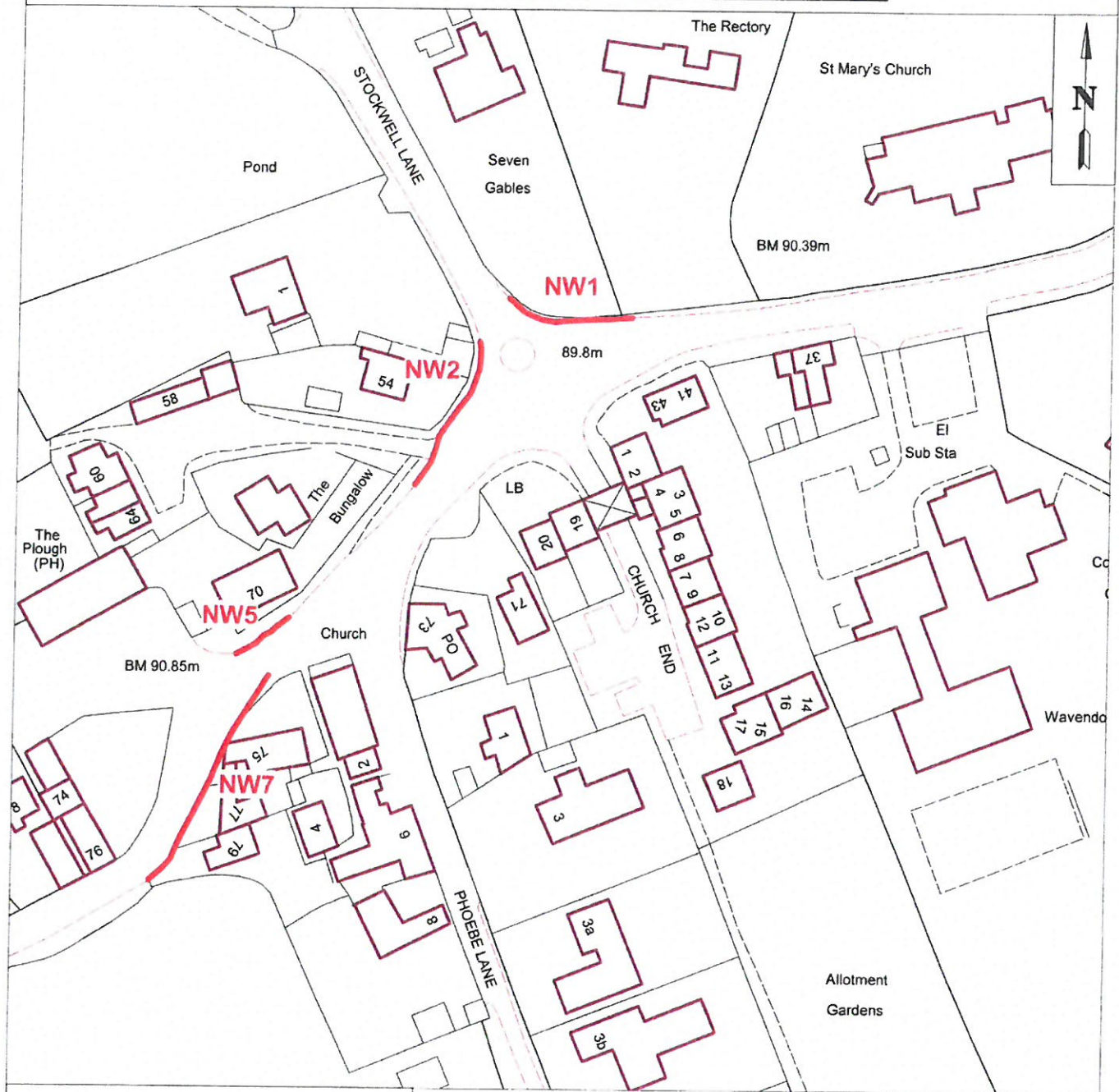

0 4,464
centimeters
Scale: 1:1,089

 No Waiting at Any Time Restriction
NW1 TRO reference number

Map referred to in The Council of the Borough of Milton Keynes
(The Council of the Borough of Milton Keynes) (Various Roads,
Wavendon) (Prohibition of Waiting and Loading Restrictions)
Order 2012) Variation Order 2017

The Common Seal of the Council of the Borough of Milton
Keynes was hereunto affixed in the presence of:



SERVICE DIRECTOR FOR LEGAL AND DEMOCRATIC SERVICES



23331

MAP 2 FOR ORDER



0 1,181
centimeters

Scale: 1:1,089

— No Waiting at Any Time Restriction
NW3 TRO reference number

Map referred to in The Council of the Borough of Milton Keynes
(The Council of the Borough of Milton Keynes) (Various Roads,
Wavendon) (Prohibition of Waiting and Loading Restrictions)
Order 2012) Variation Order 2017

The Common Seal of the Council of the Borough of Milton
Keynes was hereunto affixed in the presence of:

[Handwritten signature]



23331

SERVICE DIRECTOR FOR LEGAL AND DEMOCRATIC SERVICES

MAP 3 FOR ORDER

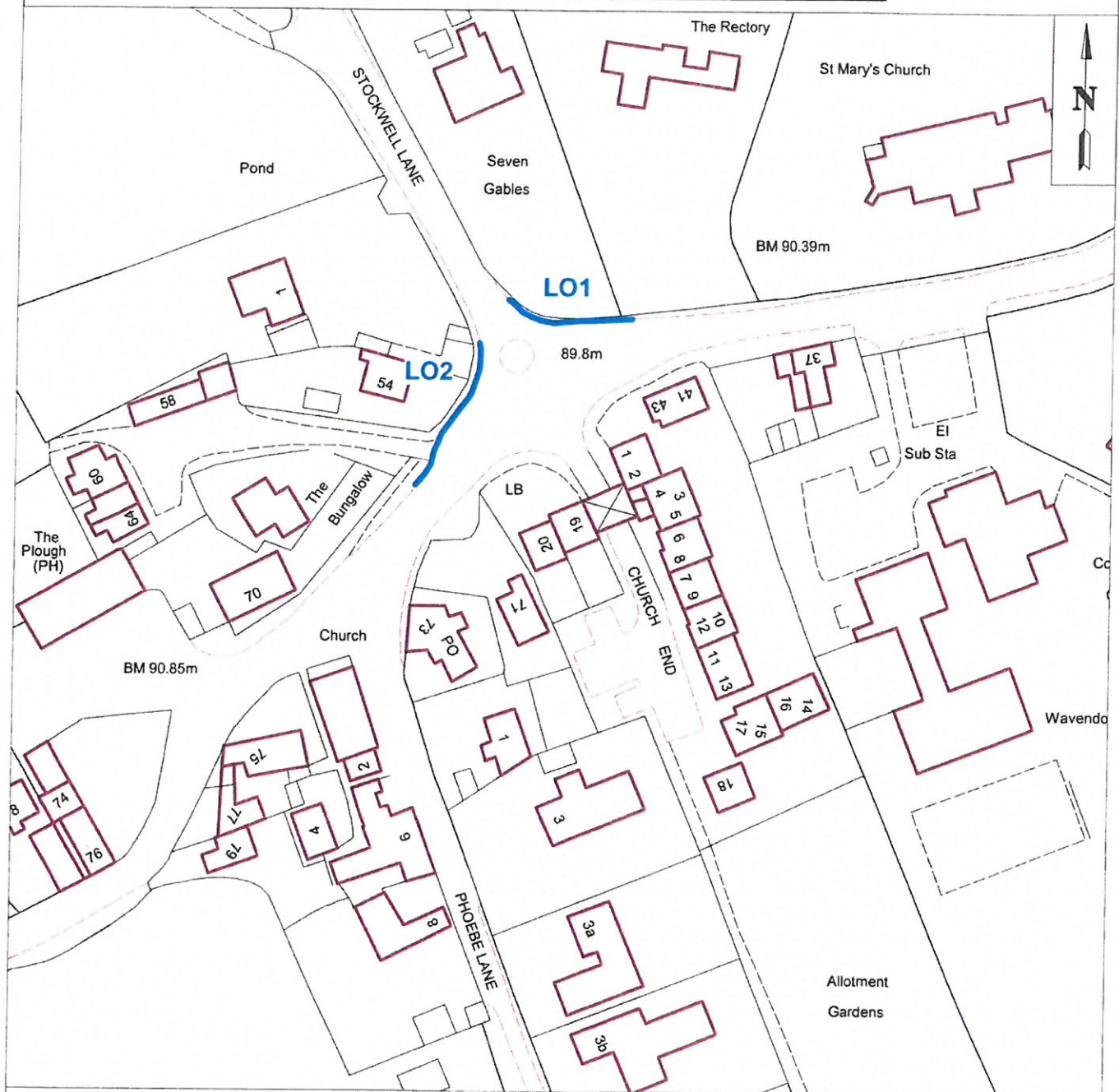

0 4,464
centimeters

Scale: 1:1,089

No Loading/Unloading at Any Time Restriction

LO1

TRO reference number

Map referred to in The Council of the Borough of Milton Keynes
(The Council of the Borough of Milton Keynes) (Various Roads,
Wavendon) (Prohibition of Waiting and Loading Restrictions)
Order 2012) Variation Order 2017

The Common Seal of the Council of the Borough of Milton
Keynes was hereunto affixed in the presence of:

[Signature]

SERVICE DIRECTOR FOR LEGAL AND DEMOCRATIC SERVICES



23331

8. Items LO1 and LO2 in Schedule 2 of the principal Order is revoked and replaced by the following:-

STOCKWELL LANE, WAVENDON

NORTH-EAST SIDE

- LO1 From its junction with the northern kerbline of Walton Road, continuing for a distance of 40.6 metres in a northerly direction

NORTH-WEST SIDE

- LO2 From its junction with the northern kerbline of Walton Road, continuing for a distance of 32.2 metres in a northerly direction

---- END ----

THE COMMON SEAL of the
COUNCIL OF THE BOROUGH OF
MILTON KEYNES as hereunto
affixed this 21st day of February
2017 in the presence of:-



.....
SERVICE DIRECTOR FOR LEGAL AND DEMOCRATIC SERVICES

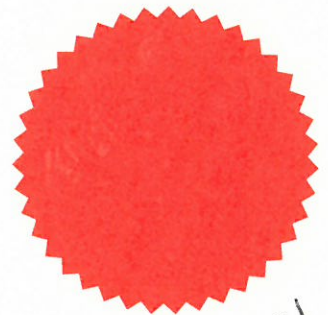

23331